

J.L. WINGERT CO.

Specification Sheet FLOODED SUCTION KITS OPTION []

SS102202.D 02/17

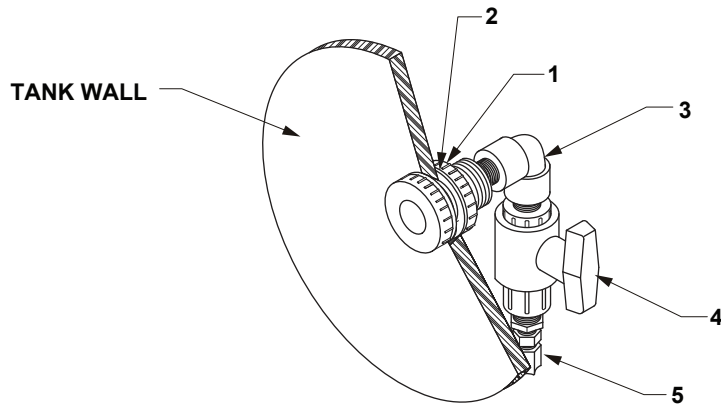

SPECIFICATIONS

KEY	PART	DESCRIPTION
	L	1/4" TUBING FLOODED SUCTION KIT
	M	3/8" TUBING FLOODED SUCTION KIT
	N	1/2" TUBING FLOODED SUCTION KIT
	AA	1/2" NPT FLOODED SUCTION KIT
	CC	3/4" NPT FLOODED SUCTION KIT
	SS	2" NPT FLOODED SUCTION KIT
1		ADAPTER: Constructed of gray Sch. 80 PVC with both threaded and slip connections
2		GASKET: Standard gasket material is EPDM
3		ELBOW: Constructed of Sch. 80 PVC
4		BALL VALVE: Constructed of gray Sch. 80 PVC and compact in design with teflon ball valve seals
5		TUBING CONNECTOR: Constructed from polypropylene

TYPICAL USES

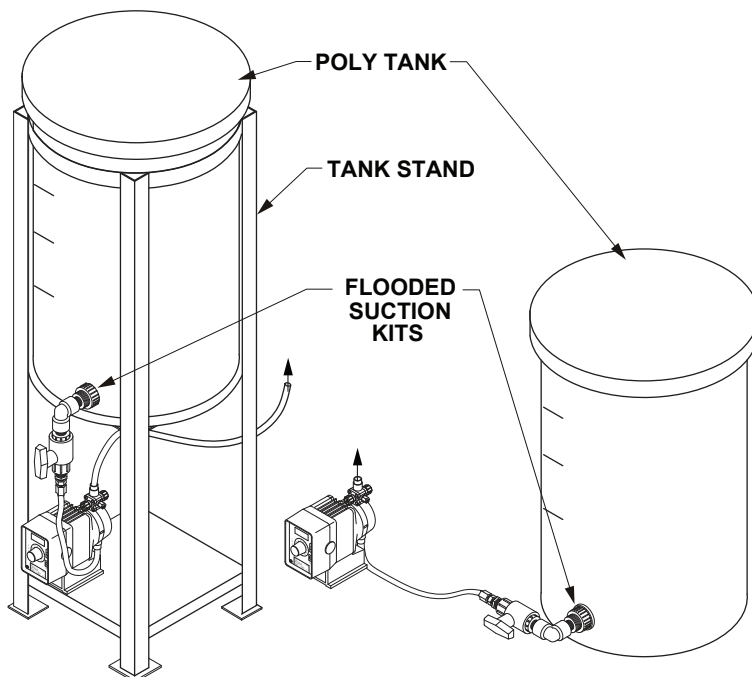

Note: All dimensions are +/- 1/8". All weights are approximate. All dimensions are subject to change without notice.

MANUFACTURING: Mixers, Bypass Feeders, Filter Feeders, Bromine Feeders, Sample Coolers, Sludge Traps, Separators, Separator Systems, Tank Stands, Tank Package Systems, Glycol Feed Systems, Coupon Racks, Control Stations, NEMA Enclosures, Custom Packaged Systems and Specialty Welding

P.O. Box 6207 | Garden Grove, CA 92846-6207 / 11800 Monarch St. | Garden Grove, CA 92841-2113 | Phone (714) 379-5519 | Fax (714) 379-5549
Northern California Region | Phone (510) 487-5310 | Southwest Region | Phone (602) 470-1015 | Email: customerservice@jllwingert.com

www.jllwingert.com