

J.L. WINGERT CO.

Specification Sheet 3" NPT, REMOVABLE DOME SEPARATOR MODEL RTE-0300

SS050004.A 03/16

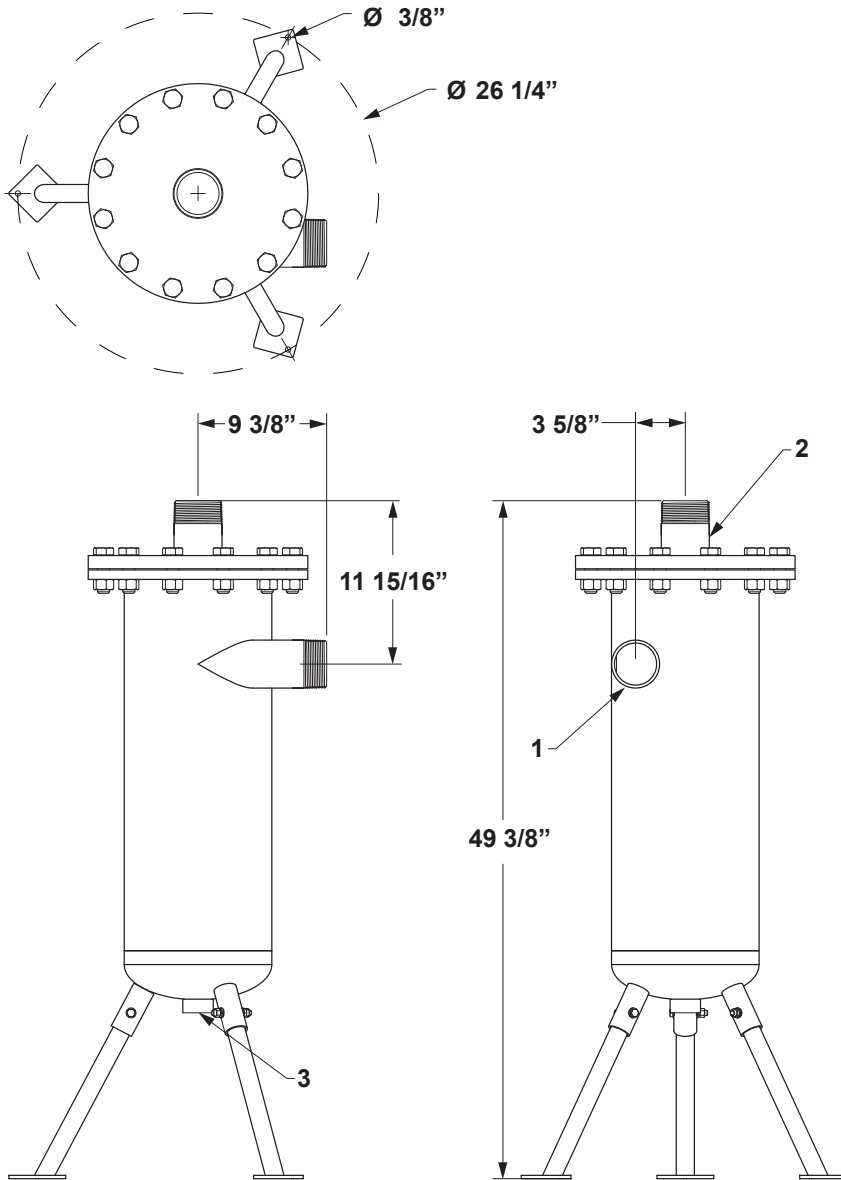

SPECIFICATIONS:

RTE-0300	Body is constructed of carbon steel and painted with water based enamel. All hardware is plated steel.
-----------------	--

FLOW RANGE:

MODEL	4 PSI DROP	12 PSI DROP
RTE-0300	205 GPM	355 GPM

DIMENSIONS:

KEY	DESCRIPTION
1	3" MNPT inlet
2	3" MNPT outlet
3	1 1/2" FNPT drain
WEIGHT	198 lbs
PRESSURE	150 PSI (10.3 bar) max
TEMPERATURE	200° F (93° C) max

Note: All dimensions are +/- 1/8". All weights are approximate. All dimensions are subject to change without notice.

MANUFACTURING: Mixers, Bypass Feeders, Filter Feeders, Bromine Feeders, Sample Coolers, Sludge Traps, Separators, Separator Systems, Tank Stands, Tank Package Systems, Glycol Feed Systems, Coupon Racks, Control Stations, NEMA Enclosures, Custom Packaged Systems and Specialty Welding

P.O. Box 6207 | Garden Grove, CA 92846-6207 / 11800 Monarch St. | Garden Grove, CA 92841-2113 | Phone (714) 379-5519 | Fax (714) 379-5549
Northern California Region | Phone (510) 487-5310 | Southwest Region | Phone (602) 470-1015 | Email: customerservice@jllwingert.com

www.jllwingert.com