

PARTS LIST		
KEY	ITEM	DESCRIPTION
1	INLET	5" FF 150#
2	STRAINER	5" CAST IRON STRAINER W/ STAINLESS STEEL BASKET
3	PUMP	GOULDS: 10AI2N9H0 600 GPM @ 80TDH 20HP TEFC MOTOR
4	SKID	EPOXY COATED CARBON STEEL
5	CONTROL PANEL	NEMA 4X ENCLOSURE MAIN POWER DISCONNECT MAIN POWER LED INDICATOR PUMP H-O-A SWITCH PUMP RUNNING LED INDICATOR PURGE H-O-A SWITCH SYSTEM PURGING LED INDICATOR ALARM LED INDICATOR 460VAC TO 120VAC TRANSFORMER PUMP CONTACTOR AND OVERLOAD PROGRAMMABLE PURGE CONTROLLER REMOTE START/STOP TERMINALS (24VDC) REMOTE PURGE TERMINALS (24VDC)
6	SEPARATOR	XFD-0500 FLOW RATE AT 4 PSID: 554 GPM FLOW RATE AT 12 PSID: 959 GPM
7	MOTORIZED PURGE	1-1/2" FNPT 120VAC FULL PORT MOTORIZED BALL VALVE
8	DISCHARGE	5" RF 150#

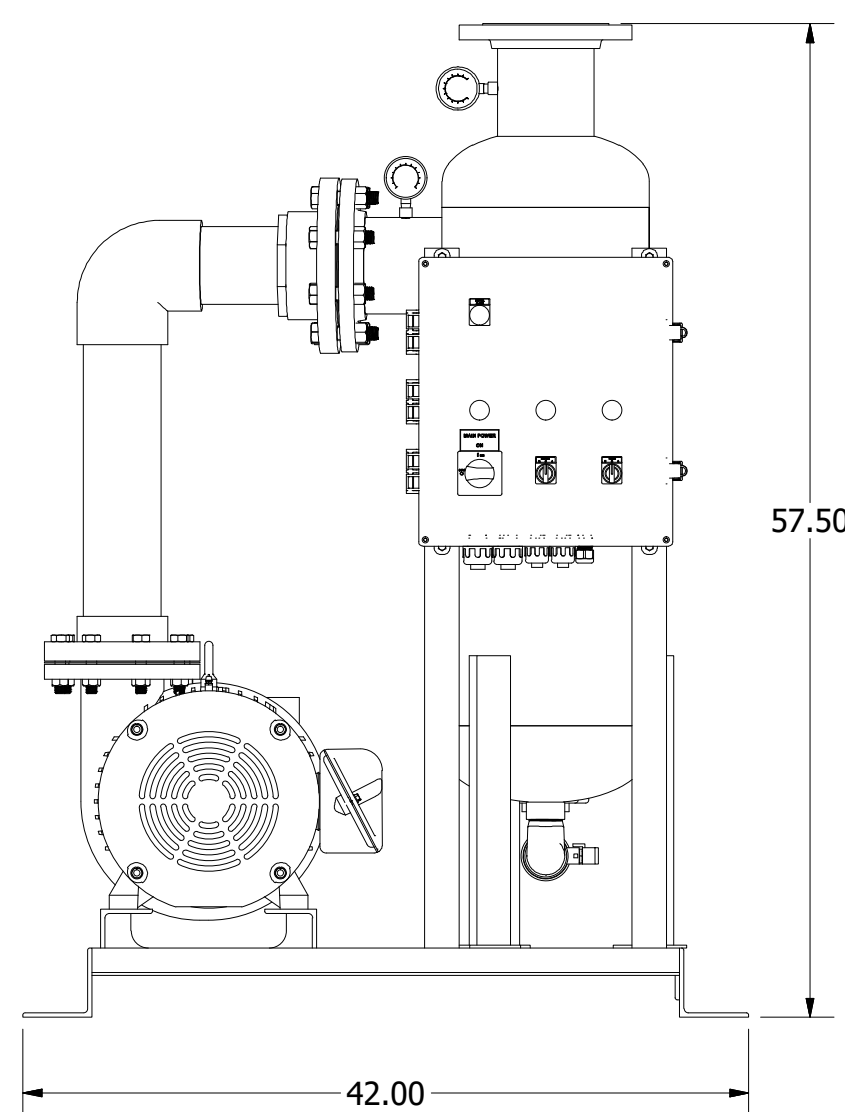

DRAWN RB	4/23/2020	J.L. WINGERT CO.	
CHECKED			
QA		TITLE JLW 600GPM @ 80TDH SEPARATOR SYSTEM - SUBMITTAL	
MFG		SIZE C	DWG NO CT-0600-80-MPK_BS
APPROVED		SCALE 0.09 : 1	REV SHEET 1 OF 1

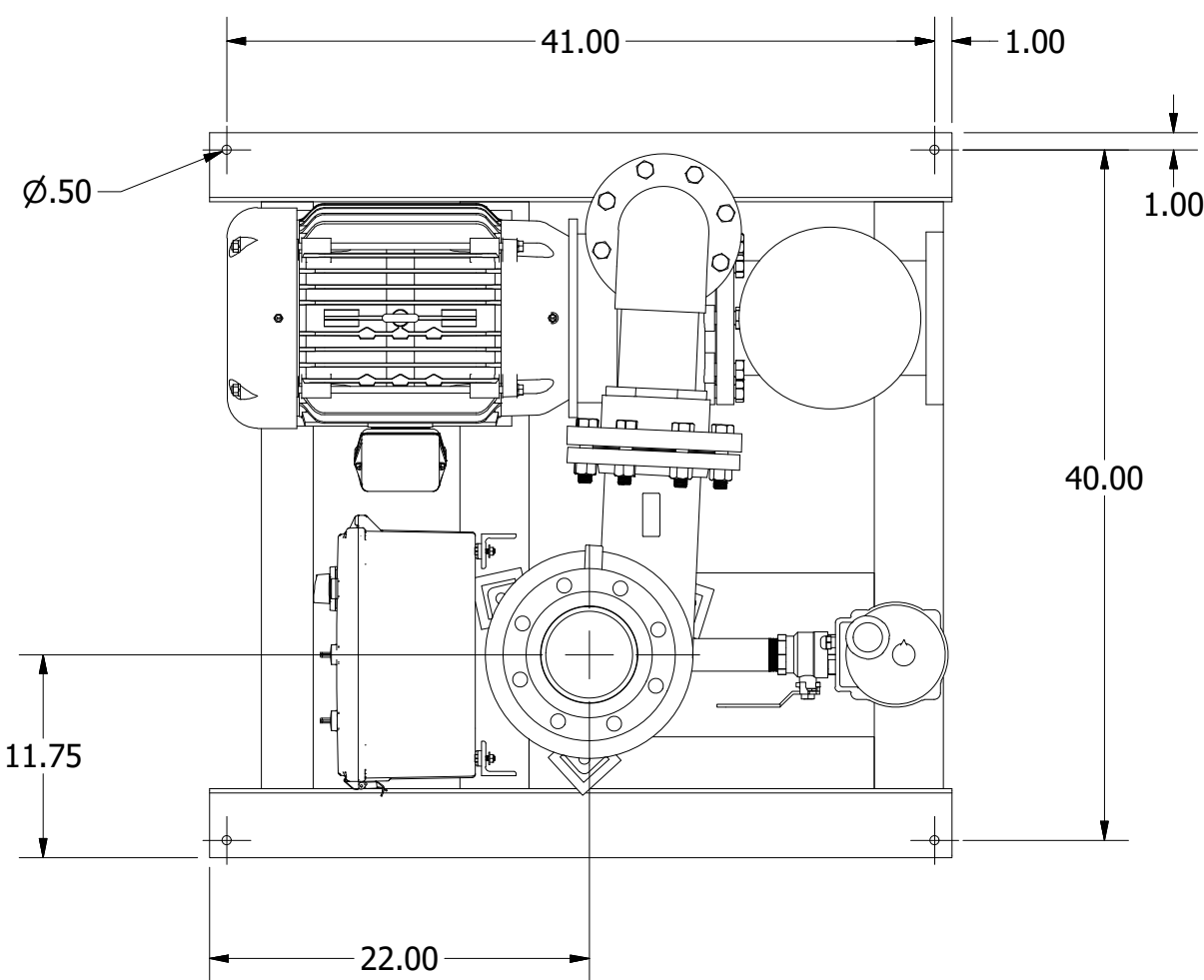

Customer	Date	30.10.2020
Contact	Project	
Phone number	Project no.	
Email		

10A11N9H0

Operating data

Pump type	Fluid	Water
No. of pumps / Reserve	Operating temperature t A	°F 39.2
Nominal flow US g.p.m.	pH-value at t A	7
Nominal head ft	Density at t A	lb/ft ³ 62.4
Static head ft	Kin. viscosity at t A	ft ² /s 1.689E-5
Inlet pressure psi	Vapor pressure at t A	psi 14.5
Environmental temperature °F	Solids	0
Available system NPSH ft	Altitude	ft 0

Pump data

Make	Goulds Water Technology	Nominal	US g.p.m.	602.6 (602.6)
Speed	rpm 3600	Flow	Max-	US g.p.m. 840
No. of stages	1		Min-	US g.p.m.
Max. casing pressure	psi		Nominal	ft 80.7
Max. working pressure	psi 45.7	Head	at Qmax	ft 47.7
Head H(Q=0)	ft 110		at Qmin	ft 105.4
Weight	lb 672	Shaft power	hp 18.1 (18.1)	
	Max. inch 8 1/16	Max. shaft power	hp 19	
Impeller R	designed inch 5 3/4	Efficiency	% 68	
	Min. inch 5 3/4	NPSH 3%	ft 11.8	

Shaft Seal

Type 21	Xylem
Car/Cer/Buna (Std.) [Max Temp. 212°F/100°C]	
Rotary	Carbon
Stationary	Ceramic
Elastomers	Buna-N
Metal Parts	316 SS
Application	General Use, Clean Water to 212°F/100°C, Non-Fluctuating Temp

Motor data

Specific design	3ph TEPE	Speed	3500 rpm	Insulation class	F
Electric voltage	460 V	Frame size	256JM	Colour	RAL 5010
Type	230/460V 256JM (C14A32F5BK2S)	Degree of protection	IP 55		
Rated power	20 hp	Electric current	23 A		

Remarks:



Customer	Date	30.10.2020
Contact	Project	
Phone number	Project no.	
Email		

10AI1N9H0

Pump Materials

100 - Casing	Gray cast iron ASTM A48 CL20B
101 - Impeller	Gray cast iron ASTM A48 CL20B
103 - Casing wear ring	Gray cast iron ASTM A48 CL20B
108 - Adapter	Gray cast iron ASTM A48 CL20B
178 - Impeller key	Carbon Steel
184 - Seal housing (One piece with adapter)	Gray cast iron ASTM A48 CL20B
198 - Impeller bolt	AISI Type 300 series stainless steel
199 - Impeller washer	AISI Type 300 series stainless steel
370 - Hex head cap screw (adapter to case)	Steel SAE 1200 Grade 5
371 - Hex head cap screw (adapter to motor)	Steel SAE 1200 Grade 5
383 - Mechanical seal	See seal chart
408 - Pipe plug 1/4" or 3/8"	Steel
513 - O-ring	BUNA-N

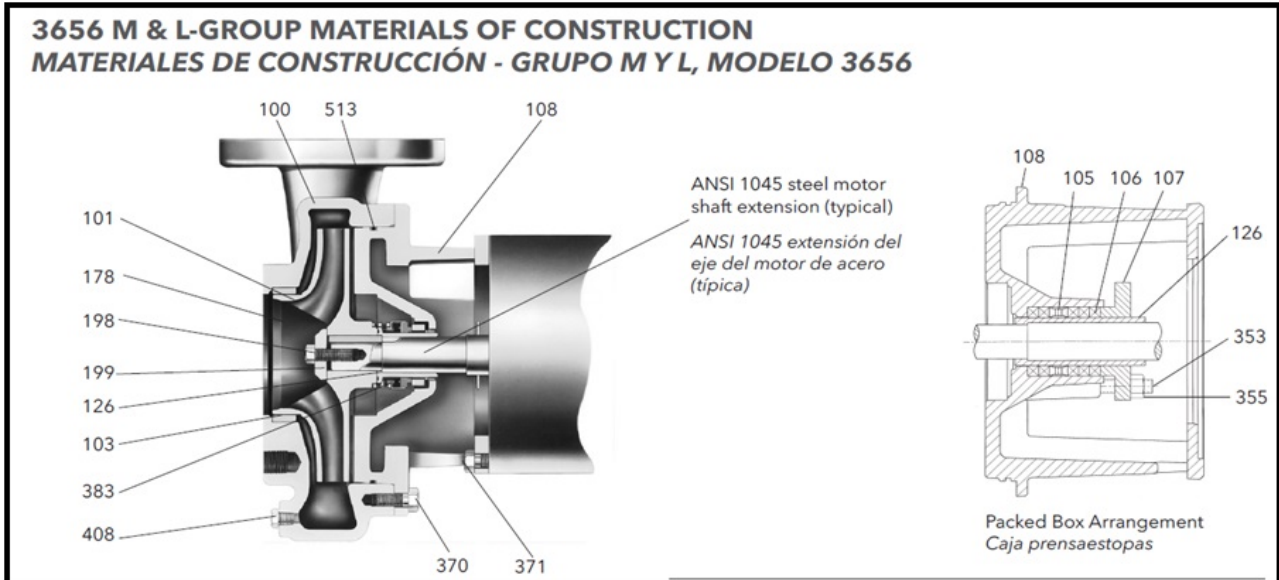

Remarks:



Customer		Date	30.10.2020
Contact		Project	
Phone number		Project no.	
Email			

10A1N9H0

Hydraulic Data

Operating Data Specification		Hydraulic data (duty point)		Impeller design	
Flow	600 US g.p.m.	Flow	603 US g.p.m.	Impeller R	5 ³ / ₄ "
Head	80 ft	Head	80.7 ft	Frequency	60 Hz
Static head	0 ft			Speed	3600 rpm

Power data referred to:
 Water [100%] ; 39.2°F; 62.4lb/ft³; 1.69E-5ft²/s
 Performance according to ISO 9906:2012 – Grade 3B

