

J.L. WINGERT CO.

Specification Sheet 1/4" SAMPLE VALVE AND INSTALLATION TEE OPTION 01

SS163501.D 05/16

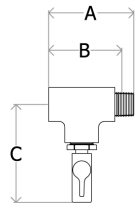

OPTION 01 FOR
PCR CORROSION
COUPON RACK

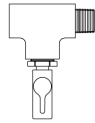

OPTION 01 FOR
CCR CORROSION
COUPON RACK

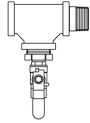

OPTION 01 FOR
CSCR CORROSION
COUPON RACK

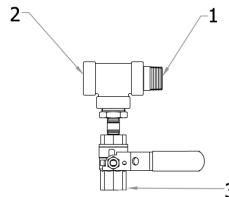

OPTION 01 FOR
SSCR CORROSION
COUPON RACK

| KEY | DESCRIPTION | |
|-----|-------------|-----------|
| 1 | INLET | 3/4" MNPT |
| 2 | OUTLET | 3/4" FNPT |
| 3 | SAMPLE PORT | 1/4" FNPT |

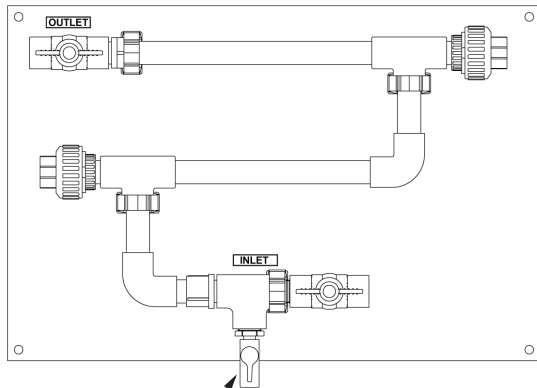

OPTION 01
EXAMPLE OF OPTION 01 ON PCR-2-007/01

| DIMENSION | MODEL NUMBER | | | |
|-------------------------|--------------|------------|-------------|-------------|
| | PCR-__-007 | CCR-__-007 | CSCR-__-007 | SSCR-__-007 |
| A | 3 3/4" | 3 3/4" | 3 1/2" | 3 1/2" |
| B (Installed Length) | 3 1/4" | 3 1/4" | 3" | 3" |
| C | 4 5/16" | 4 5/16" | 3 7/16" | 4 15/16" |

| TEMPERATURE (°F / °C) | NON-SHOCK PRESSURE RATING | | | | | | | |
|--------------------------|---------------------------|------|-------|------|----------------------|------|-----------------------------|------|
| | PVC | | CPVC | | Carbon Steel (CS) | | 316 Stainless Steel (SS) | |
| | PSI | BAR | PSI | BAR | PSI | BAR | PSI | BAR |
| 73° / 23° | 150.0 | 10.4 | 235.0 | 16.2 | 300.0 | 20.6 | 300.0 | 20.6 |
| 90° / 32° | 112.5 | 7.7 | 213.8 | 14.7 | 300.0 | 20.6 | 300.0 | 20.6 |
| 110° / 43° | 75.0 | 5.2 | 180.9 | 12.4 | 300.0 | 20.6 | 300.0 | 20.6 |
| 130° / 54° | 45.0 | 3.1 | 145.7 | 10.0 | 300.0 | 20.6 | 300.0 | 20.6 |
| 150° / 66° | N/A | N/A | 110.4 | 7.6 | 300.0 | 20.6 | 300.0 | 20.6 |
| 200° / 93° | N/A | N/A | N/A | N/A | 265.0 | 18.2 | 265.0 | 18.2 |
| 250° / 121° | N/A | N/A | N/A | N/A | 185.0 | 12.7 | 185.0 | 12.7 |

**Note: All dimensions are +/- 1/8". All dimensions are subject to change without notice.
See Operation & Maintenance Manual for part numbering.**

MANUFACTURING: Mixers, Bypass Feeders, Filter Feeders, Bromine Feeders, Sample Coolers, Sludge Traps, Separators, Separator Systems, Tank Stands,
Tank Package Systems, Glycol Feed Systems, Coupon Racks, Control Stations, NEMA Enclosures, Custom Packaged Systems and Specialty Welding

P.O. Box 6207 | Garden Grove, CA 92846-6207 / 11800 Monarch St. | Garden Grove, CA 92841-2113 | Phone (714) 379-5519 | Fax (714) 379-5549
Northern California Region | Phone (510) 487-5310 | Southwest Region | Phone (602) 470-1015 | Email: customerservice@jllwingert.com

www.jllwingert.com