

# J.L. WINGERT CO.

## Specification Sheet AIR RELEASE VALVE MODEL AR

SS032023.D 05/16

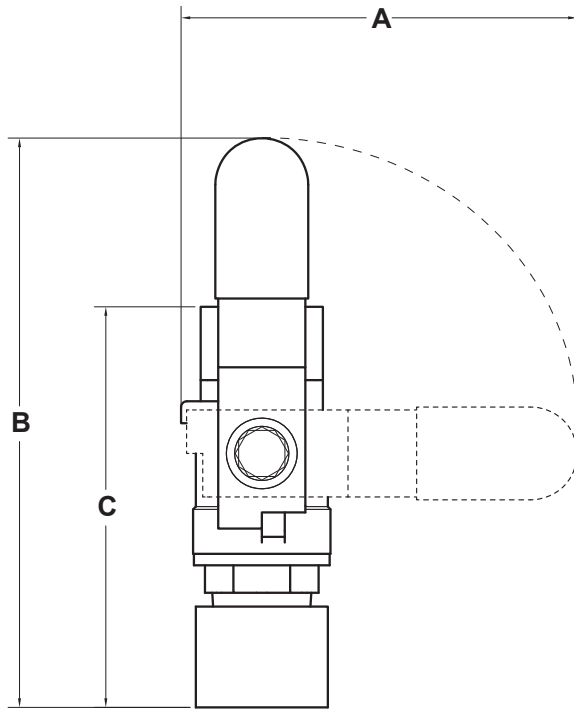

**NOTE:** Broken line shows valve in closed position

### SPECIFICATIONS

KEY	DESCRIPTION
AR	Air release valve is 1/4" NPT and is constructed of brass. 1/4" carbon steel half coupling is welded into top dome of feeder.
MAX. PRESSURE	300 PSI (20.68 BAR)
MAX. TEMPERATURE	200° F (93° C)

### DIMENSIONS

KEY	AR
A	2 1/8"
B	3"
C	2 3/16"
WEIGHT	1/2 lbs. approx.
SHIPPING DIMENSIONS	1 1/2" x 1 1/2" x 3"

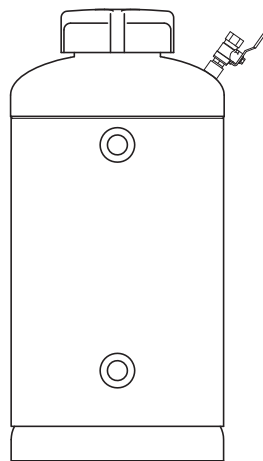

Example: 5HD/AR

**Note:** All dimensions are +/- 1/8". All weights are approximate. All dimensions are subject to change without notice.

**MANUFACTURING:** Mixers, Bypass Feeders, Filter Feeders, Bromine Feeders, Sample Coolers, Sludge Traps, Separators, Separator Systems, Tank Stands, Tank Package Systems, Glycol Feed Systems, Coupon Racks, Control Stations, NEMA Enclosures, Custom Packaged Systems and Specialty Welding

P.O. Box 6207 | Garden Grove, CA 92846-6207 / 11800 Monarch St. | Garden Grove, CA 92841-2113 | Phone (714) 379-5519 | Fax (714) 379-5549  
Northern California Region | Phone (510) 487-5310 | Southwest Region | Phone (602) 470-1015 | Email: customerservice@jllwingert.com

[www.jllwingert.com](http://www.jllwingert.com)